

NONMETALLIC WIRE MANAGEMENT RACEWAYS AND ACCESSORIES

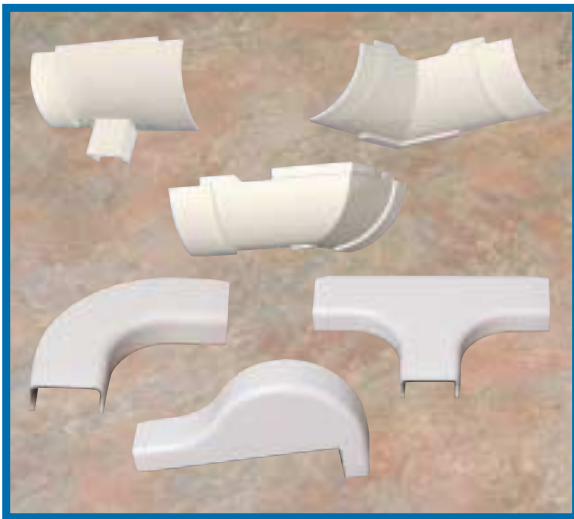

Distributed By

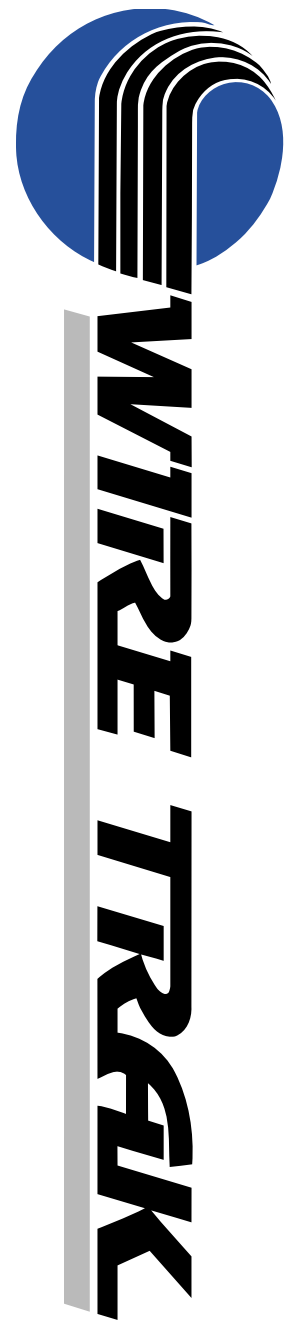

FRAM TRAK INDUSTRIES
205 Hallock Avenue ■ Middlesex, NJ 08846 ■ Phone (732) 424-8400 Fax (732) 424-8811
<http://www.framtrak.com> <http://www.wiretrakusa.com>

NON METALLIC WIRING MANAGEMENT SYSTEMS

A functional, affordable, attractive solution for wire enclosure applications in commercial, industrial and residential environments. The product line includes extruded raceway with pre-applied adhesive backing, fittings, junction boxes, ground wire guards and spiral tubing. All the parts needed to custom design a wire management system.

FEATURES

- Parts are made of a strong, durable, lightweight, UL 94-VO compliant PVC.
- One inch minimum bend radius accessories available for Category 5e, 6 and fiber optic installations.
- Custom colors upon request.
- All products are paintable.
- 3 Stocked colors in 6 and 8 foot lengths.

All parts listed below are white (indicated as “W” in the part number). For ivory, replace “W” with “I” and for beige, use “B” custom colors upon request.

1-PIECE LATCHING RACEWAYS				
SERIES	PART NUMBER	DESCRIPTION	PACKAGE QUANTITY	PACKAGE QUANTITY
375	FE020375SR-W	3/4" x 1/2" One-Piece Raceway	20 pcs @ 6' length (120')	20 pcs @ 8' length (160')
500	FE020500SR-W	1" x 1/2" One-Piece Raceway	20 pcs @ 6' length (120')	20 pcs @ 8' length (160')
1125	FE0201125SR-W	1 1/2" x 3/4" One-Piece Raceway	20 pcs @ 6' length (120')	20 pcs @ 8' length (160')

FEATURES

- Co-extruded one piece design featuring a patented, durable, flexible hinge connecting the base and cover.
- Comes in 3 sizes with complete line of molded accessories.
- Parts made from a UL VO-94 compliant PVC.
- Comes with pre-applied foam tape for speedy installation.



2-PIECE FLEX TAB RACEWAYS

SERIES	PART NUMBER	DESCRIPTION	PACKAGE QUANTITY	PACKAGE QUANTITY
375	FE020375FT-W	3/4" x 1/2" Two-Piece Flex Tab Raceway	20 pcs @ 6' length (120')	20 pcs @ 8' length (160')
500	FE020500FT-W	1" x 1/2" Two-Piece Flex Tab Raceway	20 pcs @ 6' length (120')	20 pcs @ 8' length (160')
1125	FE0201125FT-W	1 1/2" x 3/4" Two-Piece Flex Tab Raceway	20 pcs @ 6' length (120')	20 pcs @ 8' length (160')

FEATURES

- Co-extruded base with 2 flexible tabs allow for easy installation and removal of wires
- Excellent for vertical drops and overhead installations. Flexible tabs hold wire in place throughout installation.
- Co-extruded clear base allows for easy viewing of wires and cable. Base also available in 3 standard colors upon request.
- Snap on cover also available in 3 standard colors.
- Comes in 3 sizes with complete line of molded accessories.
- Parts made from a UL VO-94 compliant PVC.
- Comes with pre-applied foam tape for speedy installation.



2-PIECE SURFACE RACEWAYS

SERIES	PART NUMBER	DESCRIPTION	PACKAGE QUANTITY	PACKAGE QUANTITY
375	FE020375R-W	3/4" x 1/2" Two-Piece Raceway	20 pcs @ 6' length (120')	20 pcs @ 8' length (160')
500	FE020500R-W	1" x 1/2" Two-Piece Raceway	20 pcs @ 6' length (120')	20 pcs @ 8' length (160')
1125	FE0201125R-W	1 1/2" x 3/4" Two-Piece Raceway	20 pcs @ 6' length (120')	20 pcs @ 8' length (160')

FEATURES

- Separate base and cover design with positive locking mechanism.
- Comes in 3 sizes with complete line of molded accessories.
- Parts made from a UL VO-94 compliant PVC.
- Comes with pre-applied foam tape for speedy installation.



CORNER DUCT RACEWAYS AND FITTINGS

SERIES	PART NUMBER	DESCRIPTION	PACKAGE QUANTITY	PACKAGE QUANTITY
1075	FE0201075CD-W	1 1/16" Corner Raceway	20 pcs @ 6' length (120')	20 pcs @ 8' length (160')
1150	FE0201150CD-W	2 3/16" Corner Raceway	20 pcs @ 6' length (120')	20 pcs @ 8' length (160')
1250	FE0201250CD-W	2 3/4" Corner Raceway	20 pcs @ 6' length (120')	20 pcs @ 8' length (160')

FEATURES

- Triangular corner raceway blends into wall/ceiling junctions to provide clean, finished appearance.
- Comes in 3 sizes with complete line of molded accessories.
- Parts made from a UL VO-94 compliant PVC.
- Comes with pre-applied foam tape for speedy installation.



ACCESSORIES

SERIES	PART NUMBER	DESCRIPTION	PACKAGE QUANTITY
Ceiling Entry			
375	FMCE375-W	3/4" W x 1/2" H	10
500	FMCE500-W	1" W x 1/2" H	10
1125	FMCE1125-W	1 1/2" W x 3/4" H	10
Joint Cover			
375	FMSC375-W	3/4" W x 1/2" H	10
500	FMSC500-W	1" W x 1/2" H	10
1125	FMSC1125-W	1 1/2" W x 3/4" H	10
End Cap			
375	FMEC375-W	3/4" W x 1/2" H	10
500	FMEC500-W	1" W x 1/2" H	10
1125	FMEC1125-W	1 1/2" W x 3/4" H	10
3 Way Tee			
375	FM3T375-W	3/4" W x 1/2" H	10
500	FM3T500-W	1" W x 1/2" H	10
1125	FM3T1125-W	1 1/2" W x 3/4" H	10
Flat Elbow			
375	FM90375-W	3/4" W x 1/2" H	10
500	FM90500-W	1" W x 1/2" H	10
1125	FM901125-W	1 1/2" W x 3/4" H	10
Inside Corner			
375	FMIN375-W	3/4" W x 1/2" H	10
500	FMIN500-W	1" W x 1/2" H	10
1125	FMIN1125-W	1 1/2" W x 3/4" H	10
Outside Corner			
375	FMOC375-W	3/4" W x 1/2" H	10
500	FMOC500-W	1" W x 1/2" H	10
1125	FMOC1125-W	1 1/2" W x 3/4" H	10
4 Way Tee			
375	FM4T375-W	3/4" W x 1/2" H	10
500	FM4T500-W	1" W x 1/2" H	10
1125	FM4T1125-W	1 1/2" W x 3/4" H	10
Fiber Optic Elbow			
375	FMFO375-W	3/4" W x 1/2" H	10
500	FMFO500-W	1" W x 1/2" H	10
1125	FMFO1125-W	1 1/2" W x 3/4" H	10

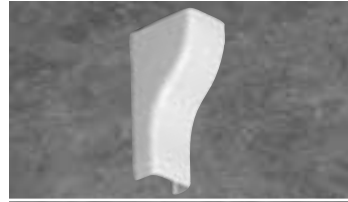

Ceiling Entry



Joint Cover



End Cap

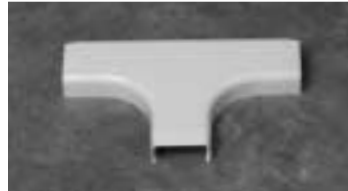

3 Way Tee



Flat Elbow



Inside Corner



Outside Corner



4 Way Tee

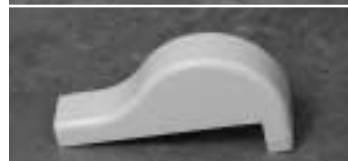

Fiber Optic Elbow

WIRE GUARDS

PART NUMBER	DESCRIPTION	PACKAGE QUANTITY
Ground Wire Guard		
FE0001109-W	1/2" U Channel	125 pcs @ 8' length (1000')
FE0001116-W	3/4" U Channel	63 pcs @ 8' length (504')
FE0001118-W	1" U channel	63 pcs @ 8' length (504')
FE0001119-W	1 1/2" U Channel	25 pcs @ 8' length (200')
FE0001120-W	2" U Channel	25 pcs @ 8' length (200')
FE0001123-W	3" U Channel	10 pcs @ 8' length (80')
FE0001125-W	4" U Channel	5 pcs @ 8' length (40')
Flanged Wire Guard		
FE0001109F-W	1/2" U Channel	75 pcs @ 8' length (600')
FE0001116F-W	3/4" U Channel	50 pcs @ 8' length (400')
FE0001118F-W	1" U Channel	50 pcs @ 8' length (400')
FE0001119F-W	1 1/2" U Channel	25 pcs @ 8' length (200')
FE0001120F-W	2" U Channel	15 pcs @ 8' length (120')
FE0001123F-W	3" U Channel	10 pcs @ 8' length (80')
FE0001125F-W	4" U Channel	5 pcs @ 8' length (40')

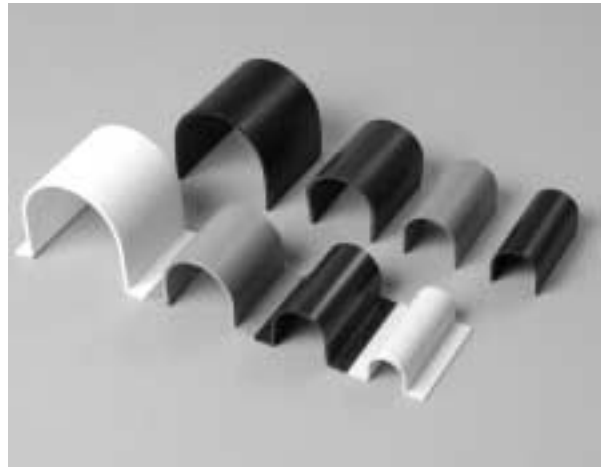

FEATURES

- Excellent for electrical and communications wiring
- Flange suitably punched for mechanical fastening
- Parts made from a UL VO-94 compliant PVC.

ACCESSORIES

SERIES	PART NUMBER	DESCRIPTION	PACKAGE QUANTITY
Fittings			
1150	FMTR1150	Tee Reducer to 3/4"	10
1150	FMIN1150	Inside Corner	10
1150	FMOC1150	Outside Corner	10

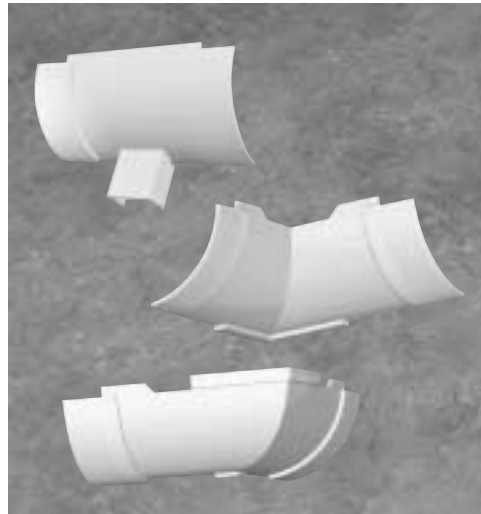

JUNCTION BOXES

PART NUMBER	DESCRIPTION	PACKAGE QUANTITY
FMJB1	Single Base and Cover	1
FMJB2	Double Base and Cover	1

FEATURES

- Wall outlet mounting holes
- Key slotted and recessed wall mounting holes
- No break off raceway alignment
- Narrow fin type cable tie anchors
- Knockouts have EZ Start drill centers for custom hole sizes
- Base is fully engraved with dimensions off center line and other details
- Smooth, flat, rib free surface
- EZ Snap tight installation
- 4 Sizes of raceway breakouts and base knockouts
- Largest insert clearance (full 2.950")
- Larger front opening for easy access
- Available in self tap or brass thread cover holes
- Heavy duty full .125 wall thickness
- Low gloss finish



RACEWAY FILL CAPACITY CHART

RACEWAY MODEL NO. AREA OF RACEWAY (Sq. In.)			375R	375SR	375FT	500R	500SR	500FT	1125R	1125SR	1125FT	1075CD	1150CD	125CD
			0.219	0.259	0.187	0.488	0.488	0.488	0.832	0.827	0.832	0.530	1.410	2.000
Wire Type	Wire Dia. (In.)	Wire Area (Sq.In.)												
Building Wire THHN														
14 AWG	0.1080	0.0092	2	3	2	5	5	5	9	9	9	6	15	22
12 AWG	0.1260	0.0125	2	2	2	4	4	4	7	7	7	4	11	16
10 AWG	0.1700	0.0227	1	1	1	2	2	2	4	4	4	2	6	9
Signal Wire UL Style 1061 300 Volt, 80 C*														
18 AWG	0.0660	0.0034	26	30	22	57	57	57	97	97	97	62	165	234
20 AWG	0.0660	0.0028	31	37	26	69	69	69	118	117	118	75	200	283
22 AWG	0.0500	0.0020	45	53	38	99	99	99	170	169	170	108	287	408
24 AWG	0.0450	0.0016	55	65	47	123	123	123	209	208	209	133	355	503
Twisted Pair Wire 24AUG*														
2 Pair	0.1400	0.0154	6	7	5	13	13	13	22	22	22	14	37	52
3Pair	0.1500	0.0177	5	6	4	11	11	11	19	19	19	12	32	45
4 Pair, CAT 5	0.2200	0.0380	2	3	2	5	5	5	9	9	9	6	15	21
25 Pair	0.5100	0.2042	0	0	0	1	1	1	2	2	2	1	3	4
Twisted Pair Wire (Shielded)*														
4 Pair, 24 AUG	0.2500	0.0491	2	2	2	4	4	4	7	7	7	4	11	16
25 Pair, 24 AUG	0.5100	0.2042	0	0	0	1	1	1	2	2	2	1	3	4
Type 1A, 22 AUG	0.4300	0.1451	1	1	1	1	1	1	2	2	2	1	4	6
COAX Cable (Max)*														
RG58/U	0.1930	0.0292	3	4	3	7	7	7	11	11	11	7	19	27
RG59/U RG62/U	0.2420	0.0460	2	2	2	4	4	4	7	7	7	5	12	17
RG6/U	0.2700	0.0572	2	2	1	3	3	3	6	6	6	4	10	14
Fiber Optic Cable 62.5/125/900, PVC JACKET, OFNR*														
2 Strand	0.1750	0.0240	4	4	3	8	8	8	14	14	14	9	23	33
4 Strand	0.1850	0.0269	3	4	3	7	7	7	12	12	12	8	21	30
6 Strand	0.2100	0.0346	3	3	2	6	6	6	10	10	10	6	16	23

* Based on 40% fill ratio

FRAM TRAK RACEWAY SIZING

1-PIECE LATCHING RACEWAYS				
MODEL	A	B	C	TAPE WIDTH
375	0.760	0.505	0.050	0.500
500	1.010	0.505	0.050	0.750
1125	1.500	0.755	0.050	1.000

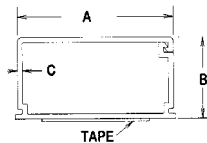

2-PIECE SURFACE RACEWAYS				
MODEL	A	B	C	TAPE WIDTH
375	0.760	0.505	0.055	0.500
500	1.010	0.505	0.055	0.750
1125	1.500	0.755	0.055	1.000

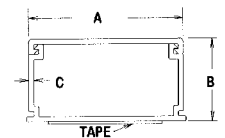

2-PIECE FLEX TAB RACEWAYS				
MODEL	A	B	C	TAPE WIDTH
375	0.850	0.550	0.030	0.500
500	1.115	0.550	0.045	0.750
1125	1.560	0.775	0.045	1.000

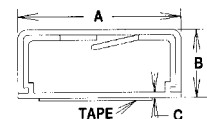

CORNER DUCT RACEWAY & FITTINGS				
MODEL	A	B	C	TAPE WIDTH
1075	1.687	0.563	0.065	0.500
1150	2.187	0.813	0.065	0.750
1250	2.750	1.094	0.070	0.7500

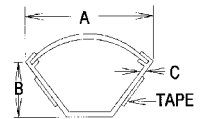

FRAM TRAK INDUSTRIES

205 Hallock Avenue
Middlesex, New Jersey 08846
Phone (732) 424-8400 ■ Fax (732) 424-8811

<http://www.framtrak.com> <http://www.wiretrakusa.com>

Represented By